

SEAS PROFESSIONAL SOUND





203

SEAS PROFESSIONAL SOUND Kit 203. A highly efficient 3-way system at a reasonable price. A 2" tweeter ensures good spatial distribution of the high frequencies.

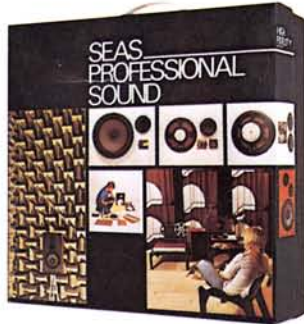

302

SEAS PROFESSIONAL SOUND Kit 302. A 2-way system with a 10" rubber surround drive unit, to ensure a good bass reproduction an a lower limiting frequency of 35 Hz. The tweeter is a 1" Dome with a resistively coated diaphragm to prevent break up. Due to its small dimensions, a good spatial distribution and an excellent transient reproduction in the high frequency region is secured.

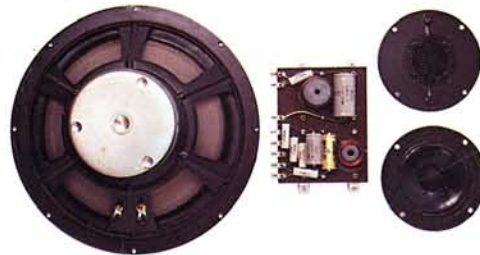
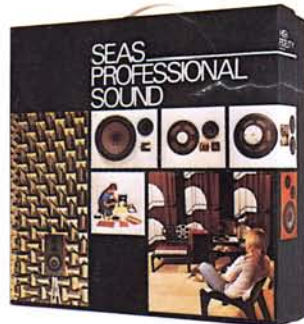

303

SEAS PROFESSIONAL SOUND Kit 303. A 3-way system with high sensitivity, excellent transient response at all frequencies, smooth radiated power response and a lower limiting frequency of 35 Hz. In order to ensure a first class transient response, the 10" rubber surround has a very powerful magnet. The midrange and tweeter units have coated diaphragms preventing cone break-up. The tweeter is a 1" Dome design exhibiting good spatial distribution of the high frequencies.

R Equipping 303 with a bass reflex port increases the efficiency in the bass region. The lower limiting frequency is then lowered from 35 to 30 Hz.

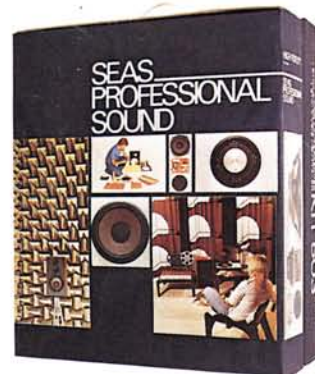

503

SEAS PROFESSIONAL SOUND Kit 503. A 3-way system with a high sensitivity and good transient response. The radiated power response is even, and the lower limiting frequency is reduced to 25 Hz. The 13" woofer with rubber surround and a long voice coil, produces very little distortion even at high power levels. The 5" high efficiency midrange has a resistive coated fabric surround preventing cone break-up. The 1" Dome tweeter with a resistively coated fabric diaphragm, ensures excellent transient reproduction and good spatial distribution of the high frequencies.



MINI KIT

SEAS MINI KIT. A small 2-way system at a reasonable price. The sensitivity is good, and a 2" tweeter secures good spatial distribution throughout the treble range.



DISCO KIT



SEAS DISCO KIT. A kit especially designed for reproducing high sound levels with little distortion. Two 12" woofers, two 6" midrange speakers, and three 4" tweeters yield an extremely high efficiency and high power handling capacity. To further protect the system against possible damage, SEAS has fitted an automatic protection device for the midrange and treble units. When the protection circuitry is engaged, the warning lights marked «tweeter protection» and «midrange protection» will light up. The bass reflex loading secures a lower limiting frequency as low as 35 Hz.

Cabinet Kit in black Vinyl, with damping material, cloth, glue and mounting instruction, is available.

KIT		203	302	303	303R	503	MINI	DISCO
Enclosure type		Closed box	Closed box	Closed box	Bassreflex	Closed box	Closed box	Bassreflex
Drive units		3-way 21F-GW 10F-LG 5TV-HF	2-way 25F-EW 1" Dome 86H	3-way 25F-EWX / 10FM / 1" Dome 86H		3-way 33F-WK 13F-GM 1" Dome 86H	2-way 17TV-W 5TV-HF	7 units 3-way 2x30F 2x15MID 3x10F-LG
Crossover network		D 005	D 037		D 036	D 030	D 046	D 047
Crossover frequencies	Hz	1500 / 4000	1500		800 / 4000	700 / 3500	5000	1000 / 4000
Frequency range ¹⁾	Hz	50-20000	35-20000	35-20000	30-20000	25-20000	60-20000 ⁴⁾	35-20000
Nominal power ²⁾	W	30	50		50	60	12	100
Music power ¹⁾	W	45	70		80	120	25	150
Operating power ¹⁾	W	2.5	5		4	2.5	3.2	0.6
Characteristic sensitivity	dB	92	89		90	92	91	98
Recomm. enclosure volume ³⁾	liter	20	30	30	35	50	12	120
Recomm. amplifier power	W	6-45	10-70		8-80	6-120	6-25	6-150
Nominal Impedance	Ohm	4 or 8	4 or 8		4 or 8	8	4 or 8	8

¹⁾ DIN 45500 ²⁾ DIN 45573 ³⁾ ±20% ⁴⁾ Does not satisfy the DIN-standard as regards its lower limiting frequency.



CABINET KITS

Cabinet kits are available for all the kits in the SEAS PROFESSIONAL SOUND range. They are designed for ease of construction, and require no special tools for assembly.

Everything the home constructor will need is included in the SEAS CABINET KITS, such as damping material, cloth and glue.

Ready assembled cabinets have an exclusive design and harmonious dimension. (Please note that the cabinets are supplied with black-varnished front).

Alternative veneer finish: Rosewood (Palisander), Teak or Walnut.

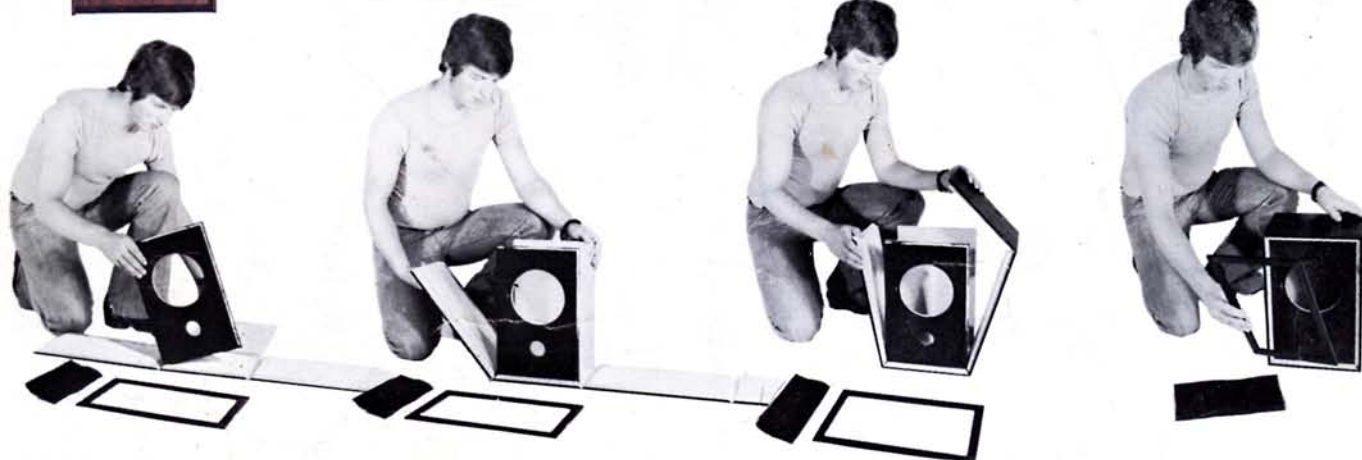

FOLDING CABINET FOR MINI

The cabinet kit for the MINI is specifically designed for ease of construction being of the Wrap Around type.

The same thoroughness that has gone into the making of our other kits is evident in the SEAS MINI KIT: Damping material, grille, cloth and glue is included.

Alternative Vinyl finish: Rosewood (Palisander), Teak or Walnut.

SEAS HI-FI KITS

The new SEAS Kits in this leaflet is the end result of an extensive research and development programme that has spared no effort in developing what we think is the most advanced range of Kits available on the market today. Computerized design methods have been used to optimise certain aspects of the systems design, but the computer has never been allowed to control the design. A strong emphasis has been placed on listening tests under various and varied conditions ensuring the greatest possible listening pleasure. This has only been possible through the extensive use of our testing and listening facilities which include anechoic and reverberation chambers, endurance test room, and several listening rooms specifically designed to mirror the acoustic environments found in real life situations.

The SEAS Kits are easily assembled without special tools or equipment, and the easy-to-wire harness eliminates the need for soldering. A metal badge for mounting on the front is included in all kits.

The specifications for every kit are included as the last page in the extensive assembly instructions that accompany all kits. This page can be glued to the back of your cabinet to give the finished product that professional look.

SEAS FABRIKKER A.S., one of Europe's largest and most up to date manufacturer of loudspeakers, guarantee the quality of the SEAS PROFESSIONAL SOUND Kits to ensure you the utmost in listening pleasure.

SEAS FABRIKKER A.S
Ryggeveien 96, Høyden
1500 MOSS, NORWAY

Akts. Videbæk Højtalerfabrik
Skandinavisk Elektroakustik A/S
6920 VIDEBÆK, DENMARK

SISO
Nyropsgade 26
DK - 1602 COPENHAGEN V.
DENMARK

SEAS